



Welcome

Nestled amidst the serene shores of Phuket's Layan Beach, Wanda Vista Resort Phuket Island Laya beckons you to a world of unparalleled luxury and tranquillity. With a commitment to providing an unforgettable resort experience for every guest, our lush retreat boasts 320 thoughtfully designed rooms.

Accommodation

Room Types	No. of Room	Area (m ²)
Deluxe Room	156	39
Club Floor	133	39
One Bedroom Suite	20	53
Two Bedroom Suite	11	65

Room Facilities



Check-in time: 15:00hrs. | Check-out time: 12:00hrs.

Attractions

Bangtao Beach	10 mins
Laguna Golf	10 mins
Kamala Beach	25 mins
Phuket International Airport	30 mins

Description

Deluxe Room Size: 39 sq.m.

- Located on the 1st and 2nd floors
- Bed: 1 King-size bed or 2 single beds

Club Floor Size: 39 sq.m.

- Located on the 3rd and 5th floors
- Bed: 1 King-size bed or 2 single beds

One Bedroom Suite Size: 53 sq.m.

- Spacious One-Bedroom Suite
- King-size bed and separate living area
- In-room coffee machine included
- Suitable for two adults and one child under 12

Two Bedroom Suite Size: 65 sq.m.

- Spacious Two-Bedroom Suite
- King-size bed and separate living area
- In-room coffee machine provided
- Accommodates two adults and two children under 12



SHUI Spa



Operating Hours: 10:00hrs. to 22:00hrs.

Experience tranquility at SHUI Spa. Our services focus on calming and soothing, using a unique blend of natural elements, herbs, wood, and water. Perfect for those seeking a serene retreat.

- Cleansing: Purify your body and mind
- Balancing: Achieve inner harmony
- Energizing: Revitalize your energy
- Spiritizing: Connect deeply with your spirit



Dining Experiences at Our Resort:

RUIKU



Operating Hours: 11:00hrs. to 22:00hrs.

Savor an exquisite fine-dining experience at RUIKU, where the spotlight is on Italian, Mediterranean, and Chinese fusion cuisines. As a versatile destination encompassing a restaurant, lounge, and bar. RUIKU invites guests to relish 96 seats for afternoon tea and evening beverages, complemented by live entertainment.

THE TASTE



Operating Hours: 06:30hrs. to 21:00hrs.

Embark on an elevated dining experience at THE TASTE. Offering a harmonious blend of International and Chinese cuisines, we serve breakfast, weekend brunch, BBQ, buffet, and an à la carte menu. With a generous seating capacity of 240, this venue provides a tranquil ambiance, allowing guests to relax and unwind.

WANVITA



Operating Hours: 08:00hrs. to 20:00hrs.

Experience the charm of WANVITA, where the aroma of freshly brewed coffee blends with the allure of delightful snacks. Embrace our uniquely designed concept for your convenience and taste. Dive into a world of flavor and comfort at WANVITA- your ideal cafe escape.

In-Room Dining

Full menu available: 06:00hrs. to 23:00hrs.

Night menu available: 23:00hrs. to 06:00hrs.

Delight in the convenience of in-room dining, and experience culinary excellence in the comfort of your room.

Pool Bar

Operating Hours: 10:00hrs. to 18:00hrs.

Immerse yourself in a refreshing poolside experience while savoring an array of cocktails, mocktails, and light snacks.

Function Rooms

Room	Width (m.)	Length (m.)	Hight (m.)	Area (m ²)
Layan	6.4	12.7	3.22 m.	81.28
Patong	6.4	12.7	3.22 m.	81.28
Kata	6.4	12.7	3.22 m.	81.28
Karon	6.3	12.7	3.22 m.	80
	25.5	12.7	3.22 m.	323.85

Floor Plan

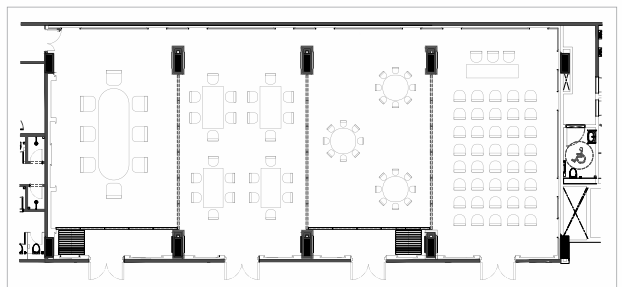

Hotel Facilities

- Pool (07:00hrs.-20:00hrs.)
- Health Club (24-hour service)
- Kids Club (09:00hrs.-17:00hrs.)
- Parking (Complimentary)

48 Moo 6, Cherngtalay Sub-District, Thalang District, Phuket 83110
 Tel. +66 (0) 7632 8888, +66 (0) 9 9998 1238 Line: @251jsqpt
 IG: @wandavistaresortphuketlaya Email: reservation@wandavistaphuket.com
 FB: facebook.com/wandavistaresortphuketislandlaya
 www.wandahotels.com