

TITANIC DELUXE LARA

CONCEPT



TITANIC

DELUXE LARA

TITANIC HOTELS

The Titanic Hotels Group story began in 1993, but the real foundations of the 'TITANIC' brand were laid in 2003 when the ship-themed Titanic Deluxe Lara Hotel opened in Lara, Antalya.

The opening of the Titanic Deluxe Lara signified the AYG Group's intention to expand and invest in the hotel sector. Buoyed by the success and synergy created by this new brand, the group decided to bring all their existing and future hotels under the umbrella of the TITANIC brand.

TITANIC HOTELS SUB-BRANDS

When it comes to operations and investments, the AYG group determine the sub-brands and concepts of their hotels according to the location and physical structure of the site.

The unique and exclusive service offered by Titanic Hotels is the result of years of experience. The hotels, which meet internationally recognised standards, are classified as follows.

PALACE HOTELS

Palace Resort

Palace City

DELUXE HOTELS

Deluxe Resort

Deluxe Golf

Deluxe City

BUSINESS HOTELS

PORT HOTELS

CITY HOTELS

COMFORT HOTELS

TITANIC HOTELS KEY FEATURES

Optimum location for its category
Outstanding professionalism in hotel management
Focus on guest satisfaction and superior service level
Guarantee of first-class materials used in every product
Premier quality food and drink concept in its category,
Compliance with stringent international hygiene standards,
Commitment to the philosophy of Total Quality with sustainable management
Utmost emphasis on guest health and safety
Rigorous Environmental Awareness,
Support and participation in social projects,
Energy-efficient service concept,
Exceptional and uninterrupted free WI-FI provision.

TITANIC HOTELS PANDEMIC MEASURES

Following the Covid 19 pandemic that began in 2020 and spread across the whole world, all TITANIC HOTELS premises immediately adopted measures to protect against this, and future, epidemics.

We always keep up-to-date with the latest instructions, recommendations and publications from The World Health Organisation (WHO), the health ministries of the Republic of Turkey and the Federal Republic of Germany and other public sector institutions, relevant professional organisations and scientific bodies.

Furthermore, the 'Hygiene and Health Procedure' meticulously followed in all TITANIC HOTELS has been reviewed, resulting in the introduction of the 'SAFE TOUCH' concept.

All our premises have 'SAFE TOURISM' accreditation, which is awarded by international auditing bodies and subject to regular, ongoing checks.



TITANIC
HOTELS

ANTALYA | ISTANBUL | BODRUM | BERLIN





GENERAL INFORMATION

Opening date: May 2003

Category: Deluxe Resort 5-Star

Company: Aygün Turizm İnşaat San. Tic. A.Ş

Season: 12 Months (Summer Season: 01.04 – 31.10; Winter Season: 01.11 – 31.03)

Total Area: 95.000 m²

Beach: 12.000 m² (Sand and grass)

Concept: De Luxe All Inclusive

Postal address: Kopak Çayı Mevkii, Lara / Antalya

Phone: +90 242 352 02 02 (03, 04)

Fax: +90 242 352 02 00

Email: deluxe.lara@titanic-hotels.com

Website: titanic.com.tr



titanichotels



titanic_hotels



titanichotels

LOCATION AND TRANSPORT

Antalya Centre	12 km
Antalya Airport	10 km
Transport Options	VIP Transfer, Taxi, Bus

* Pets not allowed.

* Use of skateboards, skates, scooters and hoverboards is not allowed in the indoor areas of the hotel.

* Use of drones is not allowed.

*** The Titanic Deluxe Lara reserves the right to make concept changes without informing second and third parties/organisations.

Situated in the Lara resort area of Antalya, one of the greatest holiday destinations in Turkey and the world, the Titanic Deluxe Lara is right on a beach that has become famous for its outstanding therapeutic sands. Its location, only 15 minutes from Antalya International Airport and 20 minutes from the centre of the resort, make it the most sought-after hotel in Lara.

Complete with meeting and congress rooms, football pitches, spacious rooms and an extensive beach, the hotel is an extremely popular, well-loved family destination offering fantastic experiences 12 months of the year.

ABOUT OUR CONCEPT

At Titanic hotels, we offer you, our valued guests, traditional Turkish hospitality and the benefit of our many years of experience. Building on this, our 2026 service is centred around the DELUXE INCLUSIVE CONCEPT, carefully curated especially for the TITANIC DELUXE LARA. Please see more details below.

WELCOME AND FAREWELL

Doorman, Valet and Bellboy services	Free Parking
Luggage Sanitation	Special welcome for guests with disabilities
Sanitised welcome and farewell packs	Room key and site guide presented in special, sanitised container.
Fast and hygienic check-in, check-out and site introduction procedures	Welcome at the door with special drinks



Guest Assistance Service

Guests staying in special room types (Colonel Suite, Admiral Suite, Duplex Suite) have a designated assistant. Our guests can contact their special assistant about anything throughout their stay.

GUEST CALL CENTRE

Our Guest Call Centre is open to all guests between 08:00 and 00:00. During check-in, guests are given the Call Centre number and asked to provide their own mobile phone number. Once check-in is complete, guests receive a 'WELCOME' message from the staff unit responsible for ensuring that all guest wishes and requests are quickly dealt with. They also share regular updates so that guests can take maximum advantage of all the hotel has to offer.

VALID CREDIT CARDS

Visa	MasterCard	Eurocard	American Express
Payment by instalment is only possible for sales made via our Call Centre.			

LANGUAGES SPOKEN

Turkish	English	German	Russian
French	Arabic		

SHOPPING FACILITIES

Shoes & Bags	Boutique for Men & Women	Market	Jewellery
Souvenirs & Trinkets	Kids Boutique	Silver	Photographic
Sportswear	Leather		

CHARGED SERVICES

Washing and Dry Cleaning service	Late check-out and Early check-in	Room Service	Premium and luxury drinks not included in the concept
Imported alcoholic beverages served by bottle	Premier wines served by a sommelier in à la carte restaurants	Cabana rental and special all-day services at the beach and pools	Box rental with special all-night services at the Show Centre
Baby Stroller, Baby Monitor	Wheelchair	Doctor Services	Spa Therapy and Wellness Services
Photocopying, printing service	Luggage Packing service		

OUR HONEYMOON CONCEPT

The best room in its category according to hotel availability	Fresh flowers in the room
Complimentary sparkling wine, fruit platter, cake and Turkish sweets on arrival	Gift heart-design cushion
VIP amenities set	Priority for à la carte reservations, Table decorations
Complimentary traditional Turkish breakfast served to the room on your chosen day	Complimentary Italian in an à la carte restaurant.
20% off BeFINE spa treatment prices	



ACCOMODATION

ROOM TYPES DESCRIPTION

Room Types	Location	Features	Max. Capacity
Standard Room	Main Building 26 m ²	Situated in the main building, standard rooms are 26 m ² and include twin or French beds, sitting area, bathroom, minibar, TV, satellite and music channels, Wi-Fi connection, direct telephone, central air conditioning, safe, shower, hair dryer, tea and coffee set-up, ceramic floor and balcony. There are 7 standard rooms especially designed for guests with disabilities.	2+2 (3 adults)
Annex Standard Garden Room	Garden 26 m ²	Situated in 2 buildings in the garden, Annex Standard Garden Rooms are 26 m ² and include twin or French beds, bathroom, minibar, TV, satellite and music channels, Wi-Fi connection, direct telephone, central air conditioning, safe, shower, hair dryer, tea and coffee set-up, ceramic floor and balcony.	2+1
Annex Standard Pool Rooms	Garden 26 m ²	Situated in 3 buildings in the garden, Annex Standard Pool Rooms are 26 m ² . Rooms on the lower floors have direct access to the pool. Annex Standard Pool Rooms include twin or French beds, bathroom, minibar, TV, satellite and music channels, Wi-Fi connection, direct telephone, central air conditioning, safe, shower, hair dryer, tea and coffee set-up, ceramic floor and balcony.	2+1
Annex Family Room	Garden 39 m ²	Located next to the ocean pool and children's pool, Annex Family Rooms consist of two-storey annex buildings in the garden. They include a balcony, minibar, TV, satellite and music channels, Wi-Fi, direct telephone, central air conditioning, safe, shower, hair dryer, ceramic floor and balcony. Lower floor family rooms: Consist of 1 large bathroom, 1 master bedroom and a second interconnected room with bunk beds and TV. Upper floor family rooms: Consist of 1 large bathroom, 1 master bedroom and a second interconnected room with beds for two children, a TV and tea and coffee set-up.	3+1
Duplex Suite	Main Building 65 m ²	Located in the main building, duplex rooms have 1 French bed. There is also a sitting area, bathroom, minibar, TV, satellite and music channels, Wi-Fi, direct telephone, central air conditioning, safe, hair dryer, capsule coffee machine and tea set-up, jacuzzi and terrace.	3+1
Junior Suite	Main Building 65 - 85 m ²	Located in the main building, Junior Suites are 65 - 85 m ² and include a French bed, seating area, minibar, LCD TV, satellite and music channels, Wi-Fi direct telephone, central air conditioning, safe, shower, hair dryer, capsule coffee machine and tea set-up, ceramic floor and balcony.	3+1
Accessible Room	Main Building 30 m ²	Located in the main building, Accessible Rooms are 30 m ² and include a French bed, balcony, bedroom, sitting area, bathroom, minibar, TV, satellite and music channels, Wi-Fi, direct telephone, central air conditioning and safe. There is a shower in the bathroom, and a hair dryer, tea and coffee set-up and ceramic floor. (Located one on each floor, the rooms offer easy access to all hotel areas by elevator and are designed to meet the needs of guests with physical disabilities. The room entrance, balcony and bathroom are designed for wheelchair access.)	2+1
Colonel Suite	Main Building 120 m ²	Located in the main building, Colonel Suites are 120 m ² and include a balcony, minibar, LCD TV, satellite and music channels, Wi-Fi, direct telephone, central air conditioning, safe, shower, hair dryer, capsule coffee machine, tea set-up and ceramic floor. Colonel Suites have a sea view and include a living room, master bedroom with king size bed, children's room with a twin bed, 1 parent's bathroom with jacuzzi, 2 WCs, 1 bathroom with a shower, and a balcony.	5+1
Admiral Suite	Main Building 80 - 150 m ²	Located in the main building, the Admiral Suites are 80 -150 m ² . One has 2 rooms and the other has 3. They can be used as a single suite or separate rooms. The Admiral Suites include king size and twin beds, mini bar, LCD TV, satellite and music channels, internet connection, direct telephone, central air conditioning, safe, capsule coffee machine, tea set-up, bathroom with shower and bathtub, hair dryer, jacuzzi, parquet floor and terrace.	5+1



SERVICES ACCORDING TO ROOM TYPE

Room Types Features	Standard Room	Annex Standard Garden Room	Annex Standard Pool Room	Port Family Rooms	Junior Suite	Colonel Suite	Admiral Suite	Duplex Suite
Balcony	X	X	X	X	X	X	X	X
Safe	X	X	X	X	X	X	X	X
Internet connection	X	X	X	X	X	X	X	X
Telephone	X	X	X	X	X	X	X	X
LCD TV	X	X	X	X	X	X	X	X
Hair dryer	X	X	X	X	X	X	X	X
Bathrobe and slippers	X	X	X	X	X	X	X	X
Kettle	X	X	X	X	X	X	X	X
Tea-coffee set up	X	X	X	X	X	X	X	X
Tea-coffee set-up and kettle	X	X	X	X	X	X	X	X
Minibar + crisps + nuts and chocolate	X	X	X	X	X	X	X	X
Central air conditioning	X	X	X	X	X	X	X	X
Music channels	X	X	X	X	X	X	X	X



FOOD AND DRINK

DE LUXE ALL INCLUSIVE FOOD AND DRINKS GENERAL INFORMATION

Excellent hygiene standards across all services	Products made daily from fresh produce in all outlets	Quality brands, local and imported goods	24-hour bar and restaurant	Snack restaurants with diverse menus
Complimentary snacks served with alcoholic drinks	Complimentary cookies served with hot drinks in the Lobby and Lounge	Wide variety of refreshments	Diverse night buffet	Complimentary Carte D'Or ice cream and waffles at specific times
Wide selection of minibar contents	Surprise treats for regular guests and Club members	Complimentary Birthday and Honeymoon treats	Special drinks service to sunbeds using QR codes at pool and beach	Special meal service for children on request

MAIN RESTAURANT

Welcome on arrival	Large, spacious indoor/outdoor sitting areas	Wide-ranging, high quality open buffet service with hygiene precautions	Freshly squeezed orange juice served at breakfast
Hot and cold drinks service to the table at breakfast	Luxury wine varieties from specific brands	Fresh bakery products service at all meals	Oven-fresh Turkish pizza selection at midday and evening times
Freshly made hot and cold food service at all meals	Grilled meat, fish and chicken varieties at all meals	Fresh cheese and deli meat buffet at all meals	Buffet with diverse selection of diet options at all meals
Buffet with diverse selection of seafoods	'Special Presentation of The Chef' buffet with evening performance	Luxury local and imported alcoholic and non-alcoholic drinks	Variety of dishes from global cuisine
Vegan Buffet			

SNACK RESTAURANTS

Welcome at the door, table service	Snack menus with wide choice of options	Sapores Italian Snack menu	Turkish Pizza, Gözleme, Pastries, Pita Pan Restaurant
Doner, Hamburger, Spit Roast Chicken varieties, Beach Stella Snack Restaurant	Quality local and imported alcoholic and non-alcoholic drinks	Evening à la carte snacks	Kikoa Kids Club Snack Restaurant

PATISserie

Wide selection of patisserie products	Freshly baked products made from superior ingredients	Self-service or table service options	Top quality, branded hot and cold non-alcoholic drinks
---------------------------------------	---	---------------------------------------	--

À LA CARTE RESTAURANTS

Reservation required	A cover charge is applied	Welcome on arrival and escorted to table	Themed atmosphere and decoration
Choice of à la carte dining or set menu	Unlimited luxury alcoholic and non-alcoholic drinks	Extensive wine menu and sommelier service	Wines and alcoholic drinks outside of the concept are charged for

FOOD AND DRINK OUTLETS SERVICE HOURS

FOOD OUTLETS

SUMMER SEASON

Restaurant	Section	Service	Details	Opening - Closing	All inclusive
Parkfora	Main Restaurant	Open buffet	Serves a wide selection of delicious world cuisines.	08:00 – 11:00 12:30 - 14:30 19:00 - 21:30	X
Children's Buffet	Main Restaurant	Open buffet	Baby Foods microwave + mixer service	08:00 - 10:30 12:30 - 13:30 18:30 - 19:30	X
Beef Grill Club	Steak House	À la carte	Serves steak and dry aged meat options.	19:00 - 22:00	Charged
Pascarella	Italian Restaurant	À la carte	Serves a wide variety of delicious Italian dishes.	19:00 - 22:00	Charged
Yamas (Open one day a week)	Greek Restaurant with a Sirtaki show	À la carte	Serves daily fresh seafoods from the special display cabinet	19:00 - 22:00	Charged
Nori	Japanese	À la carte	Serves a selection of Asian cuisines.	19:00 - 22:00	Charged
Stella Snack	Stella	À la carte	Pastries, Turkish Pizza & Snack foods	12:00 – 16:00	X

Sapores Italian Snacks	Stella	À la carte	Italian menu	11:00 - 18:00	X
Kikoa Kids Club Snack	Kikoa Kids Club	À la carte	Fast Food & Snacks	12:00 - 15:30 18:30 - 20:30	X
Night A la 'Carte Snacks	Night Snack Restaurant	À la carte	Various fast foods	23:00 - 08:00	X
Patisserie	Cordelia Patisserie	Self Service	Hot and cold pastries, sweet and savoury baked goods, various cakes and desserts,	18:30 - 23:00	X
Solaris Patisserie	Solaris Bar	Self Service	Hot and cold pastries, sweet and savoury baked goods, various cakes and desserts, fruit selection	12:00 - 18:30	X
Solaris Patisserie	Solaris Bar	Self Service	Ice cream varieties	12:00 - 23:00	X
Solaris Patisserie	Solaris Bar	Self Service	Waffles Baked Potatoes	12:00 – 18:30 16:00 – 18:00	X
Beach Patisserie	Beach Bar	Self Service	Hot and cold cakes, sweet and savoury baked goods, dessert selection,	12:00 - 18:00	X
Beach Patisserie	Beach Bar	Self Service	Fruit, Ice Cream and Waffles	12:00 - 18:00	x
Room Service	Room Service	Room Service	Selected food and drinks from the menu	24 hours	Charged

WINTER SEASON (2026-2027)

Restaurant	Section	Service	Details	Opening - Closing	All inclusive
Parkfora	Main Restaurant	Open buffet	Serves a wide selection of delicious world cuisines.	08:00 - 10:30 12:30 - 14:30 18:30 - 21:00	X
Children's Buffet	Main Restaurant	Open buffet	Baby Foods microwave + mixer service	08:00 - 10:30 12:30 - 13:30 18:30 - 19:30	Opens according to numbers of children
Beef Grill Club	Steak House	À la carte	Serves steak and dry aged meat selection	19:00 - 22:00	Charged
Pascarella	Italian Restaurant	À la carte	Serves a wide variety of delicious Italian dishes.	18:30 - 22:00	Charged

Yamas (Open one day a week)	Greek Restaurant with a Sirtaki show	À la carte	Serves daily fresh seafoods from the special display cabinet	18:30 - 22:00	Charged
Nori	Japanese	À la carte	Serves a selection of Asian cuisines.	18:30 - 22:00	Charged
Ala Carte Snacks	Italian Restaurant	À la carte	Fast Food & Snacks	14:30-18:00	X
Snacks	Night Snack Restaurant	À la carte	Various fast foods	23:00 – 24:00	X
Cordelia patisserie	Patisserie	Table service	Hot and cold pastries, sweet and savoury baked goods, various desserts,	16:30 – 23:00	X
Room Service	Menu	Room Service	Selected food and drinks from the menu	24 hours	Charged

BARS

SUMMER SEASON

Bar	Opening - Closing
Cordelia - Lobby Bar	09:00 - 24:00
Armonia - Pool Bar	10:00 - 24:00
Schiller Coffee Corner – Pool Bar	08:00 -12:00
Solaris - Pool Bar	10:00 - 24:00
Aqua Bar - Pool Bar	10:00 - 18:00
Beach Bar – Beach Bar	10:00 -18:00
Ocean Bar – Beach Bar	10:00 - 18:00
Vitamin – Indoor Pool Bar	10:00 - 19:00
Caprice – Lobby Bar	Closed
Ocean Disco Bar-Beach	23:00 - 01:00
Bowling Bar	Open 24 hours
Caprice – Patisserie	18:30 - 23:00
Pier Bar	10:00 – 18:00

WINTER SEASON

Bar	Opening - Closing
Cordelia - Lobby Bar	10:00 - 24:00
Armonia - Pool Bar	(Closed)
Solaris - Pool Bar	(Closed)
Ocean Beach Bar (Tea – Coffee Machine)	10:00 - 16:00 (Depending on the weather)
Vitamin - Indoor Pool Bar	10:00 - 19:00
Caprice - Lobby Bar	10:00 - 24:00
Bowling Bar	Open 24 hours
Patisserie	14:30 - 23:00

DE LUXE ALL INCLUSIVE DRINKS CONCEPT

SUMMER SEASON

Whiskey	Chivas Regal 12 YO	Jack Daniel's	Johnnie Walker Red Label	Johnnie Walker Black Label(Lobby Bar Only)	Ballantine's	Jim Beam
	Chivas Regal 18 YO (Lobby Bar Only)	Jameson	J&B Rare	Glenlivet 12 YO		
Vodka	Absolute	Smirnoff	Gilbey's	Finlandia		
Gin	Beefeater	Gordon's	Gilbey's	Bombay Sapphire(Lobby Bar Only)		
Rum	Havana Club 3	Captain Morgan	Havana Club 7			
Tequila	Olmecca Blanco	Olmecca Gold	Equivalent Tequila			
Cognac	VS Cognac	VS Martel	VSOP Cognac			
Rakı	Yeni Rakı	Tekirdağ Rakı Tekirdağ Gold	Efe Gold Rakı Efe Fresh Grapes	Beylerbeyi Göbek	Yeni Rakı new series	
Aperitifs	Vermouth Bianco Rosso Extra Dry	Garrone Bitter	Fernet Branca	Campari	Jägermeister	
Beers	Efes Pilsen	Miller	Heineken	Beck's	Corona	

Liqueurs	Kahlua	Malibu	Safari Drambuie	Bailey's Irish Cream	Archer's	Sambuca
----------	--------	--------	--------------------	-------------------------	----------	---------

***Some brands/options of drinks may change due to supply problems.**

WINTER SEASON

Whiskey	*Chivas Regal 12 YO (Lobby Bar Only)	J&B Rare	Ballantine's	Jack Daniels (Lobby Bar Only)	J.Walker Red Label
Vodkas	WYBOROVVA	Absolute (Lobby Bar Only)	Smirnoff		
Gin	Gilbey's	Beefeater (Lobby Bar Only)	Gordon's (Lobby Bar Only)	Kork	
Rum	Havana Club 3	Captain Morgan			
Tequila	Olmecca Bianco	Olmecca Gold	Alternative Tequila		
Cognac	Cognac VSOP	Sorau Brandy			
Rakı	Efe Gold Rakı	Efe Fresh Grape Rakı	Yeni Rakı	Tekirdağ Gold	
Aperitifs	Vermouth Bianco Rosso Extra Dry	Garrone Bitter Fernet Branca	Jägermeister	Aperitifs	
Beers	Efes Pilsen Draught	Miller (Lobby Bar Only)	Beck's		
Liqueurs	Malibu	Safari	Tia Maria	Kahlua	Baker's Field

***Some brands/options of drinks may change due to supply problems.**



BEACH AND POOLS

(Summer Concept)

350 Metre Sandy Beach	Sunbeds and Parasols	Special Sun Decks	VIP Cabana Service (charged)	Lifeguard Service
Towel Desk(with towel card system)		Drinks can be ordered at beaches and pools from sunbeds with QR code system		Beach Snack Restaurants, Patisserie and Bars

POOLS

Indoor and outdoor pools of different sizes with a variety of equipment

Pool	Outdoor	Indoor	Heated	Depth	Area m ²
Indoor Pool (Winter concept)		X	X	140 cm	170 m ²
Indoor Children's Pool (Winter concept)		X	X	30 cm	20 m ²
Outdoor Main Pool	X			140 cm	4500 m ²
Olympic swimming pool	X			185 cm	1250 m ²
Semi-Olympic Pool (Winter concept)	X		X	140 cm	315 m ²
Aquapark Pool	X			105 cm	180 m ²
Kids Slides Pool*	X			30 cm	750 m ²
* The adult aquapark can be used by children over the age of 6 (a wristband is required).Opening hours 10:00-12:30 & 13:30-17:00 Towel Desk 08:00 – 20:00					

ADULT SLIDES

1 Black Hole 63 M	1 Rafting Slide 69 M
1 Turbulence Slide 72 M	1 Aquatube 62 M

CHILDREN'S SLIDES

1 Aqua Tower	1 Octopus Slide
1 Snake Slide	1 Wide Slide
1 Kids Body Slide	1 Kids Tunnel Freefall



BEFINE SPA

Free	Fitness Centre	Turkish bath	1 steam room
	2 Saunas		Jacuzzi
	Resting rooms	Indoor pool	Outdoor pool
Charged	Massage and Hammam Services	Skin and Body Care	



KIKOA KIDS CLUB

Kikoa Kids Club has been completely redesigned for kids of all ages. Our multilingual teachers have excellent communication skills, offering children well-planned activities and endless fun.

Facilities

For the age group 01-17 years old

Baby Room for age group 1-3 -- Junior for age group 4-7 -- Maxi for age group 8-12 -- Teenage Club for age group 13-17 years old

Special shows for children (Summer concept)

Outdoor and indoor children's play areas/ Baby Spa(for 1 year old)

Birthday parties

Private birthday parties (charged)

KIKOA Kids Snack Restaurant (special Children's Snack Menu (Fast food, Ice Cream, Fruit and Dessert Selection) 12:00 – 18:00 (Summer concept)

Kikoa Kids Snack Restaurant Opening and Closing Times 12:00 – 18:00(Summer concept)

*Kikoa Kids Club service hours and venues vary according to the season.
Working hours in the summer season are between 09:00 and 00:00.
Working hours in the winter season are between 09:00 and 21:00.



ENTERTAINMENT & ACTIVITIES

DAYTIME ACTIVITIES

Morning Gymnastics and Aqua Gymnastics	Step & Aerobics	Boccia	Cinema
Latin and Belly Dance courses	Basketball	Coffee, Cards and Board Games	Football (Grass Field)
Beach Volleyball	Swimming Pool Games	Water Polo	Shooting
Bowling	Amusement Machines	Billiards	Playstation

EVENING ACTIVITIES

World-famous international performance groups and acrobatic displays (between May 1 – October 15)	Live music with orchestra	Concept Parties	Karaoke
Ocean Disco	Bowling	Billiards	Playstation

WATER SPORTS

Free	Windsurfing (Requires License)			
Charged	Diving Lessons	Water Skiing	Jet Skis	Canoeing and Pedalos (on the river)
	Parasailing	Private Swimming Lessons	Motorised Water Sports	

FITNESS CENTRE

Sports Areas	Sports complex outside the hotel containing 4 professional-size turf football pitches (2 pitches 68 m x 105 m, 2 pitches 60 m x 90 m, parking area, 500-person tribune people, 4 changing rooms, 2 referee rooms, 1 doctor's room, 1 doping room)	Mini turf football field inside the hotel
	4 tartan surface tennis courts	1 multi-purpose field
	Olympic Pool (50 m x 25 m x 1.80 m, 10 lanes and diving boards, backlighting, special chronometer)	1 stretching area is available to gym groups.
	Tennis and padel equipment rental and private lessons are subject to a fee. (The mini football field, basketball court, and tennis courts are available free of charge for hotel guests).	



MEETING FACILITIES

There is 1 large conference hall (1173 m2) that can be divided into 3 sections, along with 12 meeting rooms of different sizes. The rooms are equipped with the latest technology and are suitable for a variety of groups and organisations.

ATLANTIC HALLS

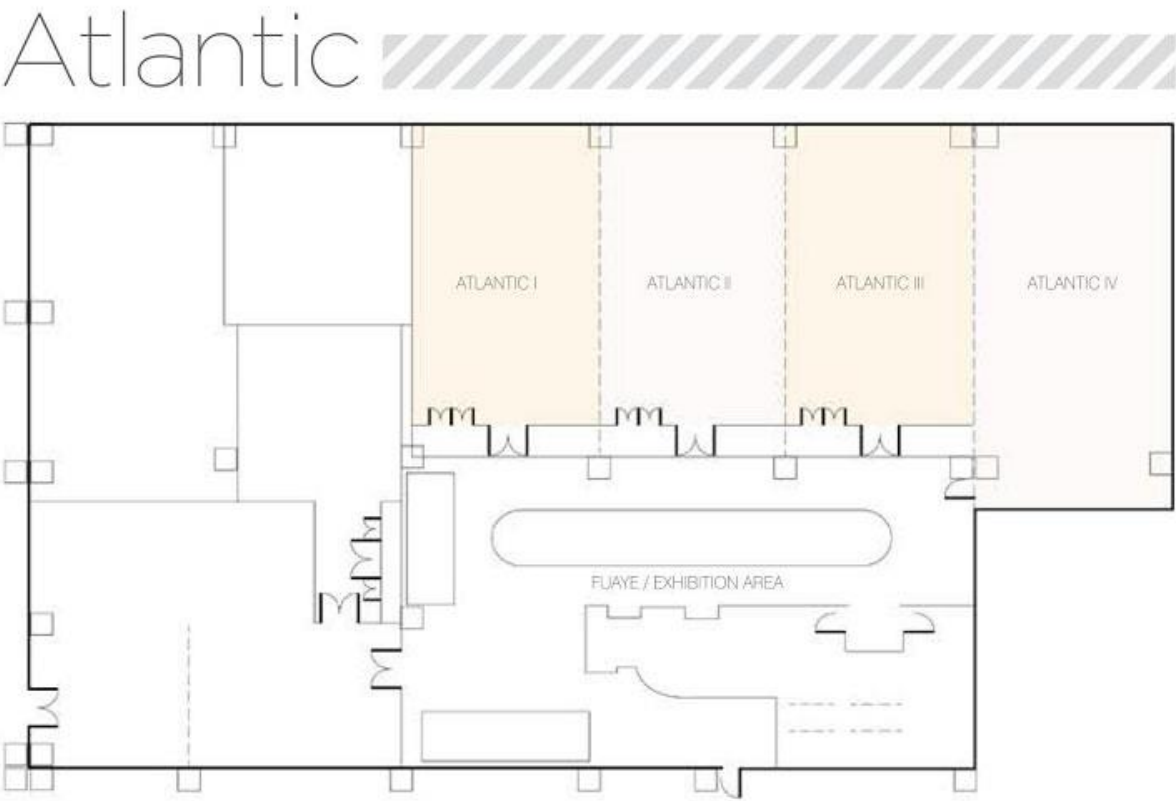

Halls	Area (m2)	Width (m)	Length (m)	Ceiling Height (m)	Banquet	Theatre	Classroom	Cocktail
Atlantic I (Daylight)	90	7.4	12.2	2.6	-	80	50	-
Atlantic II (Daylight)	90	7.4	12.2	2.6	-	80	50	-
Atlantic III (Daylight)	90	7.4	12	2.6	-	80	50	-
Atlantic IV (Daylight)	111	7.2	15.4	2.6	-	100	70	-

PACIFIC HALLS

Pacific

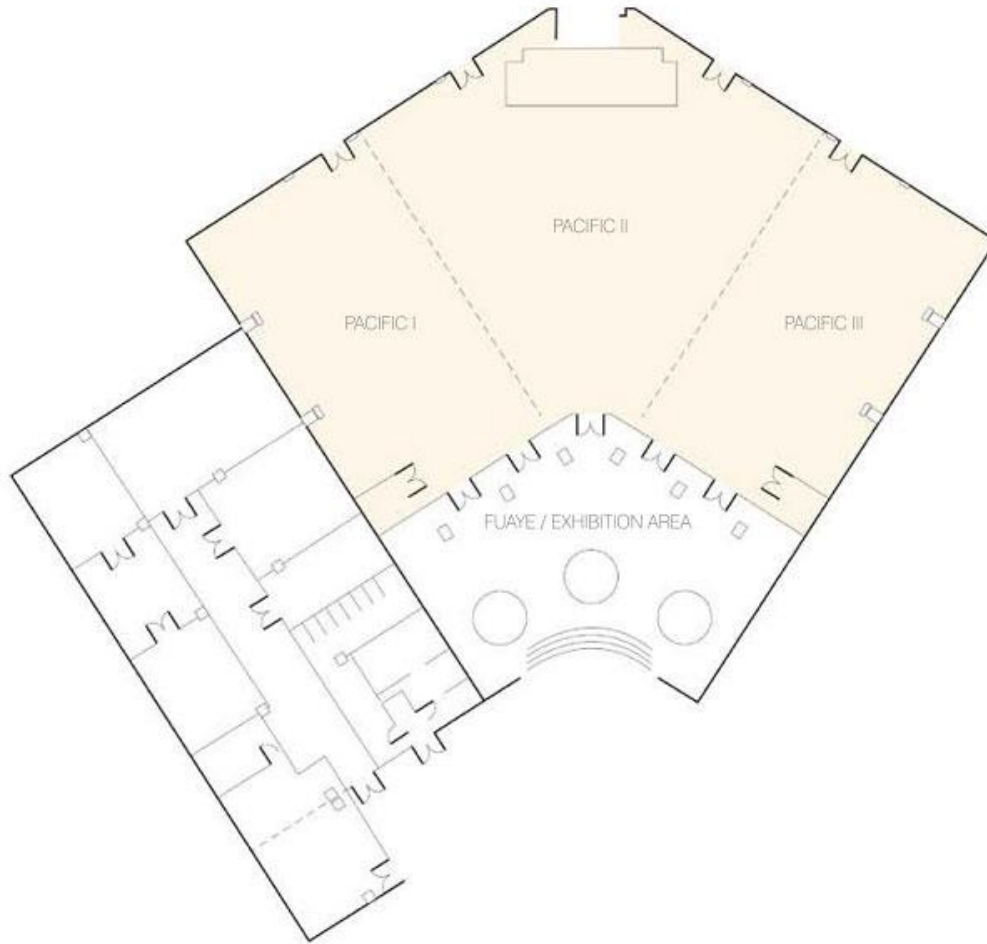

Halls	Area (m2)	Width (m)	Length (m)	Ceiling Height (m)	Banquet	Theatre	Classroom	Cocktail
Pacific	1152	24	48	5.5	1000	1500	600	1500
Foyer	340	-	-	5	-	-	-	300
Pacific I	336	14	24	4.5	150	300	150	250
Pacific II	500	20	25	4.5	300	500	250	400
Pacific III	336	14	24	4.5	150	300	150	250

BLACK SEA HALLS

Black Sea

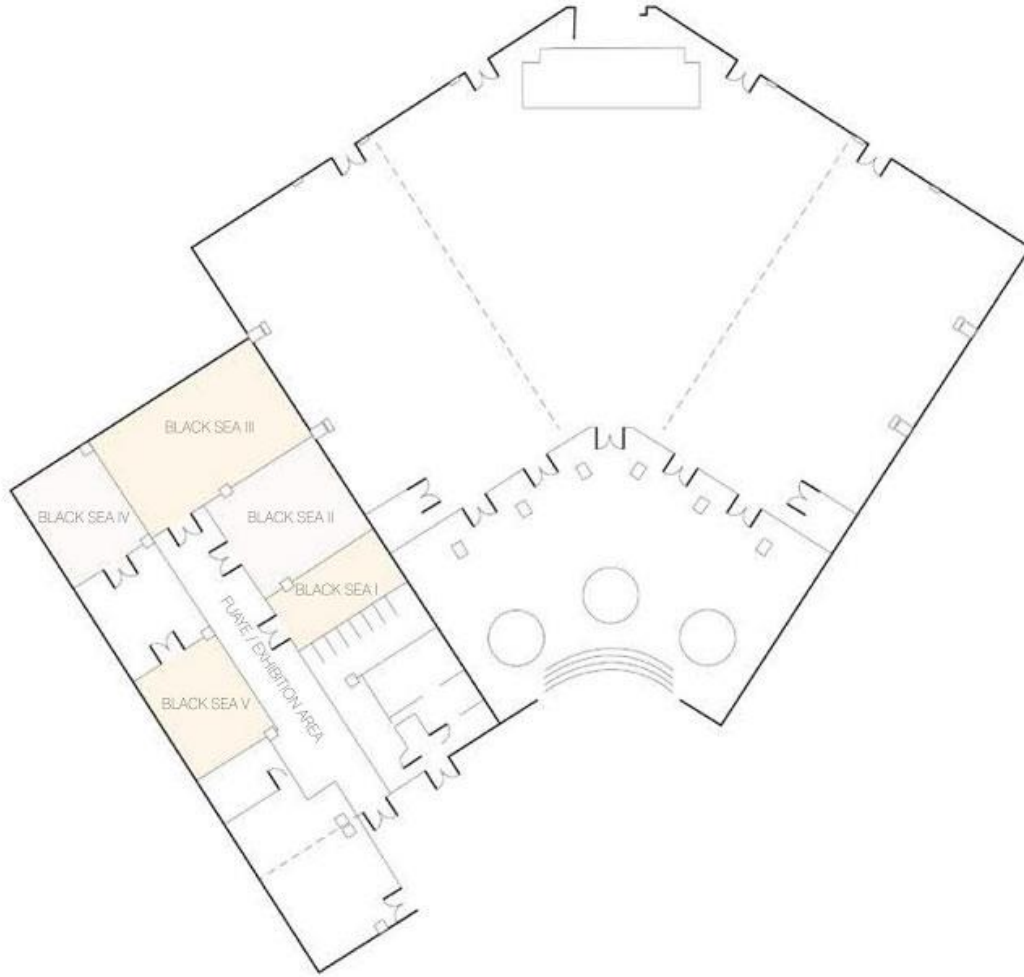

Halls	Area (m2)	Width (m)	Length (m)	Ceiling Height (m)	Banquet	Theatre	Classroom	Cocktail
Black Sea I	30	3.9	7.8	4.4	-	20	12	-
Black Sea II	58	7.4	7.9	4.4	-	50	30	-
Black Sea III	88	7.4	12	4.4	-	90	60	-
Black Sea IV	44	7.4	6	2.6	-	40	20	-
Black Sea V	44	7.4	6	2.6	-	40	20	-



CULLINAN LINKS GOLF CLUB

Cullinan Links Golf Club has the distinction of being the only golf course in Turkey that borders a river and the sea.

Cullinan Links Golf Club has been updated to a 36-hole course by "European Golf Design", the world's leading golf course design firm.

With its illuminated driving range, the Cullinan Links Golf Club offers golf lovers the pleasure of playing with a golf cart throughout all 4 seasons, as well as lessons at the Golf Academy from internationally certified golf instructors.

Official Opening	October 11, 2021
Range Area	1,100,000 m ² (110 hectares)
Opening Times	Summer: 07:00 – 19:00 Winter: 08:00 – 18:00 F&B ALL INCLUSIVE CONCEPT
Usual Wind Direction	North (Taurus Mountains) in the morning, South (Seaside) in the afternoon
Turf Type	Summer: Paspalum Winter: Poa and Lolium perenne
Measurements	Fairway markers are measured starting from the Green. Green size is 600m ² on average.
Tee Size	Average 250 m ² (White-Yellow-Red)
Bunker	Total 119 - Fairway Bunker 42
Green Bunker	77
Lakes	10 in total
River	Beşgöz Stream
Driving Range	40 turf tees (105 m), 20 sheltered tees (105 m) 36.000 m ²
Putting Green	Total 5: 1 x 1042 m ² (18 holes), 4 x average 500 m ² (9 holes)
Pitching Green	2 Chipping Greens – 735 m ² and 432 m ²
Golf Carts	64
Trolleys	240
Golf Bags for Rent	Left and right hand
Golf Lessons	Lessons at all levels are taught by PGA professionals.
Max HCP.	Men 36 HCP, Women 44 HCP

OUR SUSTAINABILITY JOURNEY

The Titanic Deluxe Lara was one of the first hotels to be accredited by the Global Sustainable Tourism Council (GSTC).

The Titanic Deluxe Lara has implemented a sustainability management system in compliance with the criteria of the GSTC Global Sustainable Tourism Council, with particular emphasis on continuous protection of the environment and natural world, respect for human rights - including social and cultural values, standing against child exploitation, protecting the rights of vulnerable groups and cooperating with local communities.

By acting responsibly in all areas necessary for delivering sustainable tourism, we try to augment the customer experience, increase awareness among staff, guests and suppliers, increase efficiency, reduce expenses, and enhance the ecosystem and human well-being. Our hotel investment plans are aimed at maintaining the optimum standards for ensuring the continuous reduction of environmental impact and encouraging sustainable development and growth.

We ask our valued guests to stand by us and give us their support on this journey.





● BERLIN

TITANIC

HOTELS

● ISTANBUL

BODRUM ●

● ANTALYA